



THE LONDONER
LEICESTER SQ.

Corner Suite

[Click to enter](#)

- ◆ Welcome
- Corner Suite
- The Residence
- The Dining Scene
- The Retreat



THE WORLD'S FIRST SUPER BOUTIQUE HOTEL

Welcome to an urban resort
in the heart of the West End.

Individual, intimate, eclectic, and curated; yet staggering in scale, The Londoner is a new hotel category of one. A perfectly engineered collection of spaces, tastes and textures brought to life over 16 storeys on London's legendary Leicester Square. The Londoner is home to 350 exquisite bedrooms and suites, six concept eateries and bars, including a rooftop lounge and tavern, a private guest residence, an urban wellness retreat, seven inspiring meeting spaces and a stunning ballroom for up to 850 guests.



THE LONDONER
LEICESTER SQ.

Welcome

◆ Corner Suite

Floor Plans

Suite Privileges

The Residence

The Dining Scene

The Retreat



CORNER SUITE

A charming metropolitan oasis with curves in all the right places, pick your preferred place to reflect made perfect by eclectic views, more beautiful space, and a selection of welcome patisseries among other exclusive suite privileges.



THE LONDONER
LEICESTER SQ.

Welcome

Corner Suite

◆ Floor Plans
Suite Privileges

The Residence

The Dining Scene

The Retreat

Corner Suite

Total Space: 36-52 m² / 388-560 ft²

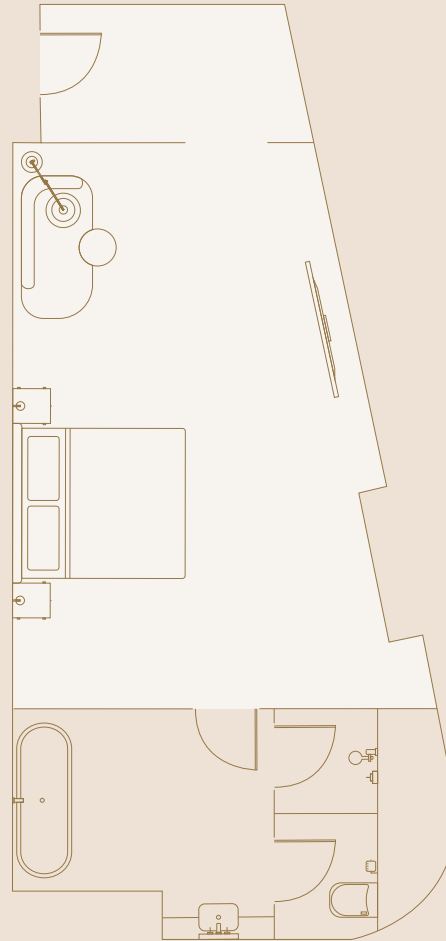

Bedroom



Bedroom

- King bed with handcrafted Vispring mattress
- 400 thread count Irish linen
- Feather down pillows and mattress topper
- Original art by Edd Pearman
- Unlimited bottled premium water
- Steamery handheld steamer
- Roberts Bluetooth radio and speakers
- Handcrafted umbrella
- In-room drawer safe
- Complimentary latest generation Wi-Fi 6
- Smart TV with Google Chromecast
- Lutron lighting control system



THE LONDONER
LEICESTER SQ.

Welcome

Corner Suite

◆ Floor Plans
Suite Privileges

The Residence

The Dining Scene

The Retreat

Corner Suite

Total Space: 36-52 m² / 388-560 ft²

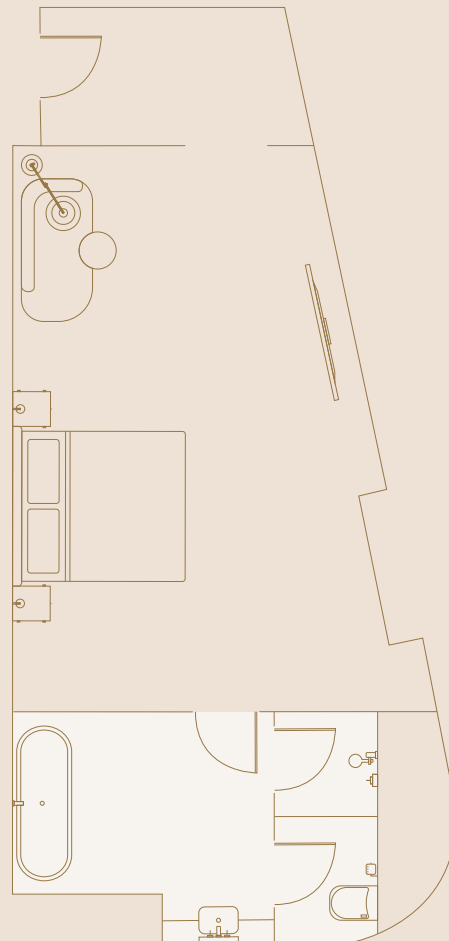

Bathroom

Bathroom

- Spacious vanity with illuminated theatre mirror
- Miller Harris bathroom amenities
- Premium Japanese Toto washlets with heated seat, jet wand cleanser and sensor-activated lid
- Luxurious bathrobe and cushioned slippers
- Bathtub and shower



THE LONDONER
LEICESTER SQ.

Welcome

Corner Suite

Floor Plans

◆ Suite Privileges

The Residence

The Dining Scene

The Retreat



Suite Privileges

- Exclusive welcome amenity
- An amuse-bouche from our Head Pastry Chef
- 24-hour host service for every need
- VIP in-room check-in/out
- Complimentary bespoke housekeeping services
- Dyson hairdryer



THE LONDONER
LEICESTER SQ.

Welcome

Corner Suite

● The Residence

The Residence

The Dining Scene

The Retreat



WELCOME TO THE RESIDENCE

A collection of three beautifully designed
spaces for hotel residents only.



THE LONDONER
LEICESTER SQ.

Welcome

Corner Suite

The Residence

◆ The Residence

The Dining Scene

The Retreat



THE LONDONER
LEICESTER SQ.

The Residence

The Residence has been curated to meet our guests' every work and relaxation needs, with complimentary antipasti, soft drinks, tea and coffee served throughout the day.

Welcome

Corner Suite

The Residence

☉ The Dining Scene

8 at The Londoner

Whitcomb's

The Stage

Joshua's Tavern

In-room Dining

The Retreat



THE DINING SCENE

The Londoner's restaurants and bars reflect the city's eclectic dining scene.

Elegant Japanese cuisine features alongside a contemporary take on the French Mediterranean. Bright and airy spaces for breakfast and brunch contrast intimate evening spots, whilst the rooftop sets the scene for spectacular gazing and grazing.



THE LONDONER
LEICESTER SQ.

Welcome

Corner Suite

The Residence

The Dining Scene

8 at The Londoner

Whitcomb's

The Stage

Joshua's Tavern

In-room Dining

The Retreat



8 at The Londoner

A decadent rooftop izakaya lounge that reimagines the informal and traditional Japanese style of dining and drinking in three stunning settings.



THE LONDONER
LEICESTER SQ.

Welcome
Corner Suite
The Residence
The Dining Scene
8 at The Londoner
◆ Whitcomb's
The Stage
Joshua's Tavern
In-room Dining
The Retreat



THE LONDONER
LEICESTER SQ.

Whitcomb's

The Londoner's signature restaurant is a place where light, artistic surroundings meet cuisine led by exclusive, seasonal ingredients. Welcome to a corner of the French Mediterranean, with a terrace overlooking Leicester Square.

Welcome

Corner Suite

The Residence

The Dining Scene

8 at The Londoner

Whitcomb's

◆ The Stage

Joshua's Tavern

In-room Dining

The Retreat



THE LONDONER
LEICESTER SQ.

The Stage

Step into the limelight of The Stage, where the drama unfolds with a spectacular programme featuring afternoon tea and life's great delights.

Welcome

Corner Suite

The Residence

The Dining Scene

8 at The Londoner

Whitcomb's

The Stage

◆ Joshua's Tavern

In-room Dining

The Retreat



THE LONDONER
LEICESTER SQ.

Joshua's Tavern

The Londoner's tavern is a homage to Sir Joshua Reynolds, 18th century portrait artist and former Leicester Square resident. Join us for regular live music performances and a contemporary bill of fare with gastro bites, beers and more than 50 types of gin.

Welcome

Corner Suite

The Residence

The Dining Scene

8 at The Londoner

Whitcomb's

The Stage

Joshua's Tavern

◆ In-room Dining

The Retreat



IN-ROOM DINING

Welcome to The Londoner's in-room dining experience – where the capital's contemporary dining scene meets elegant silver tray service.



THE LONDONER
LEICESTER SQ.

Welcome

Corner Suite

The Residence

The Dining Scene

● The Retreat

The Spa

Hair & Beauty

The Gym

Refuel



A STOREY OF WELLNESS

Welcome to The Retreat, an urban sanctuary of revitalisation that disconnects Londoners from London.



THE LONDONER
LEICESTER SQ.

Welcome
Corner Suite
The Residence
The Dining Scene
The Retreat
◆ The Spa
Hair & Beauty
The Gym
Refuel



The Spa

The spa features tranquil spaces to relax, refresh and detoxify, including a swimming pool, hydropool, sauna, steam room and secluded cabanas.



THE LONDONER
LEICESTER SQ.

Welcome
 Corner Suite
 The Residence
 The Dining Scene
 The Retreat
 The Spa
 ● Hair & Beauty
 The Gym
 Refuel



Hair & Beauty

Whether you are after the perfect blow-dry at Hiro Miyoshi Hair & Beauty, a file and finish at AMA Nails or a beard trim at Joe Vipond Gentlemen's Grooming, The Retreat's hair & beauty services will leave you looking sharp.

- Welcome
- Corner Suite
- The Residence
- The Dining Scene
- The Retreat
 - The Spa
 - Hair & Beauty
- ◆ The Gym
- Refuel



The Gym

Specifically designed to encourage high-intensive training and promote ambitious results, The Gym has partnered with Technogym to provide state-of-the-art equipment with an adjoining studio for classes.



THE LONDONER
LEICESTER SQ.

Welcome
 Corner Suite
 The Residence
 The Dining Scene
 The Retreat
 The Spa
 Hair & Beauty
 The Gym
 ◆ Refuel



Refuel

Created to supplement The Retreat's spa treatments and workout sessions, Refuel is a results-driven superfood and drinks clinic that aims to nourish and promote a holistic state of wellbeing. Discover a range of Ayurvedic breakfasts, health juices, smoothies, light lunches and more, designed to complement post workout sessions and health routines.



THE LONDONER

LEICESTER SQ.

38 Leicester Square
London WC2H 7DX
+44 (0)20 7451 0101
thelondoner.com